

**OWNER**







Antelope Valley Community College  
District  
Facilities Services Building  
3041 West Avenue K  
Lancaster, CA 93536-5426

**CONSTRUCTION MANAGER**

Ledesma & Meyer Construction Company  
Inc.  
9441 Haven Avenue  
Rancho Cucamonga, CA 91730



**SYMBOLS LEGEND**

-  -NEW DOOR AND FRAME
-  -ADA ACCESSIBLE AREA
-  -SEATING
-  -ELEVATION CALL OUT SEE ELEVATION SHEET.
-  -NEW Tandus Powerbond Rolled Flooring
-  -WOOD FLOOR REFINISHING
-  -NEW Armstrong 12"x12"x1/8" VCT Flooring

**SCHEDULE OF DRAWINGS**

- SITE PLAN.
- OVERALL BUILDING PLAN.
- EXISTING FLOOR PLAN.
- NEW LAYOUT FLOOR PLAN.
- EXISTING DIMENSIONS AND WALL ELEVATIONS.
- ELEVATIONS.





Antelope Valley College 14-220C  
Choral Renovation  
Site Plan  
3/9/15

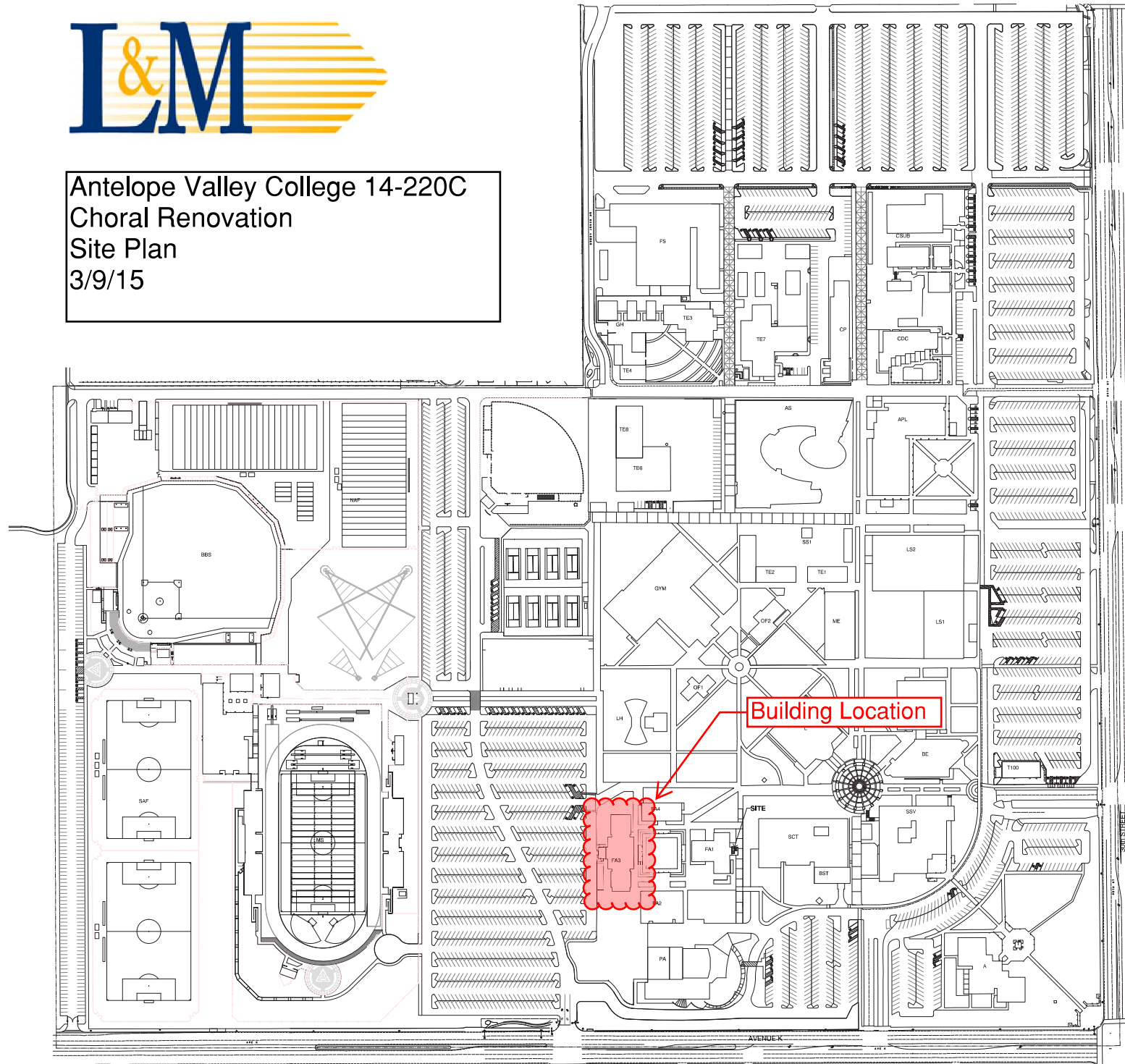

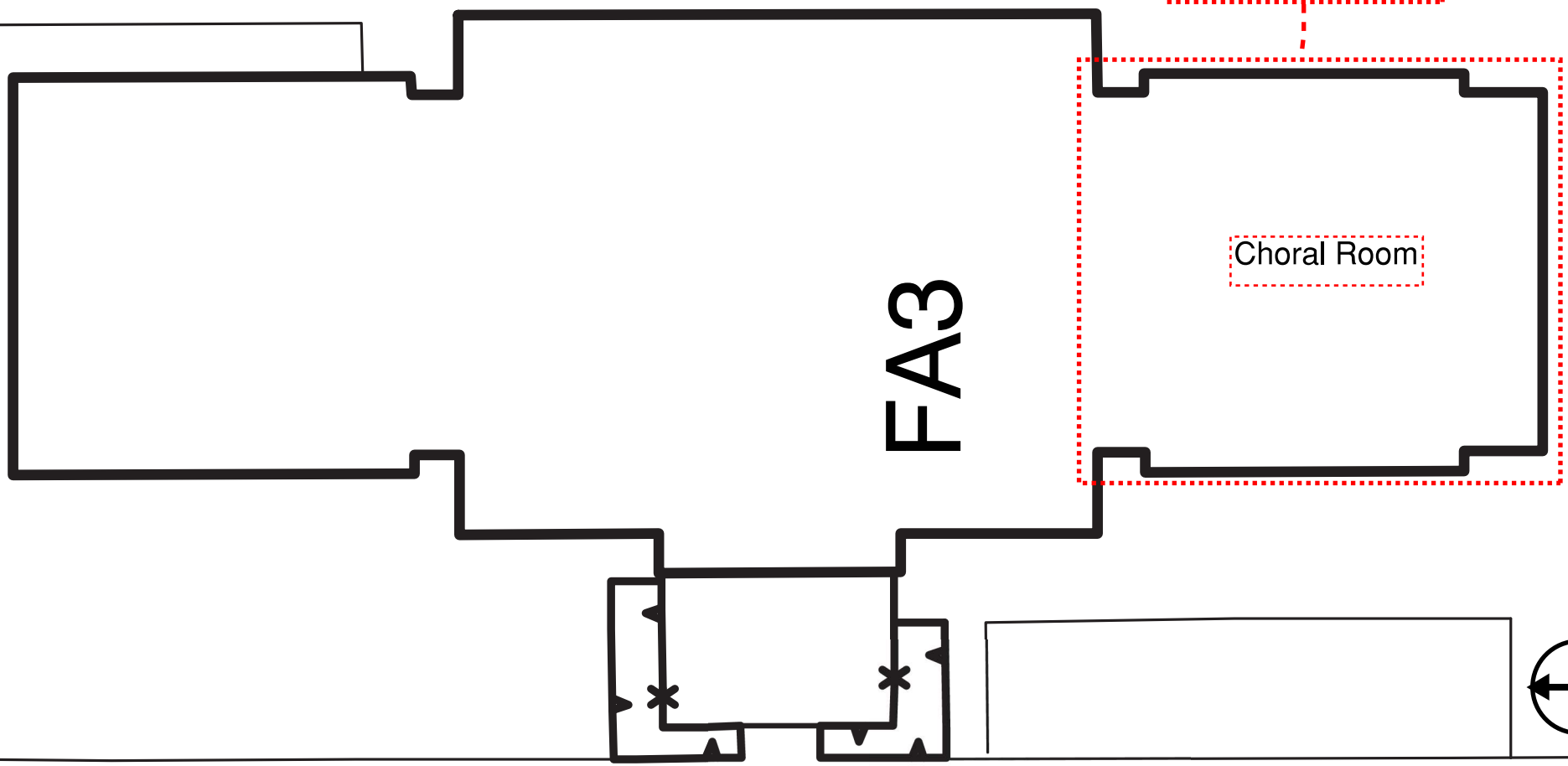

FA3

Limits of Work

Choral Room



Antelope Valley College 14-220C  
Choral Room Renovation  
Overall Building  
3/9/15

# F A 3

Wall line  
above Typ.

Riser  
Elevation  
-5-1/2" Typ.

Existing in wall  
storage closets.

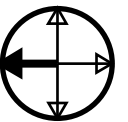
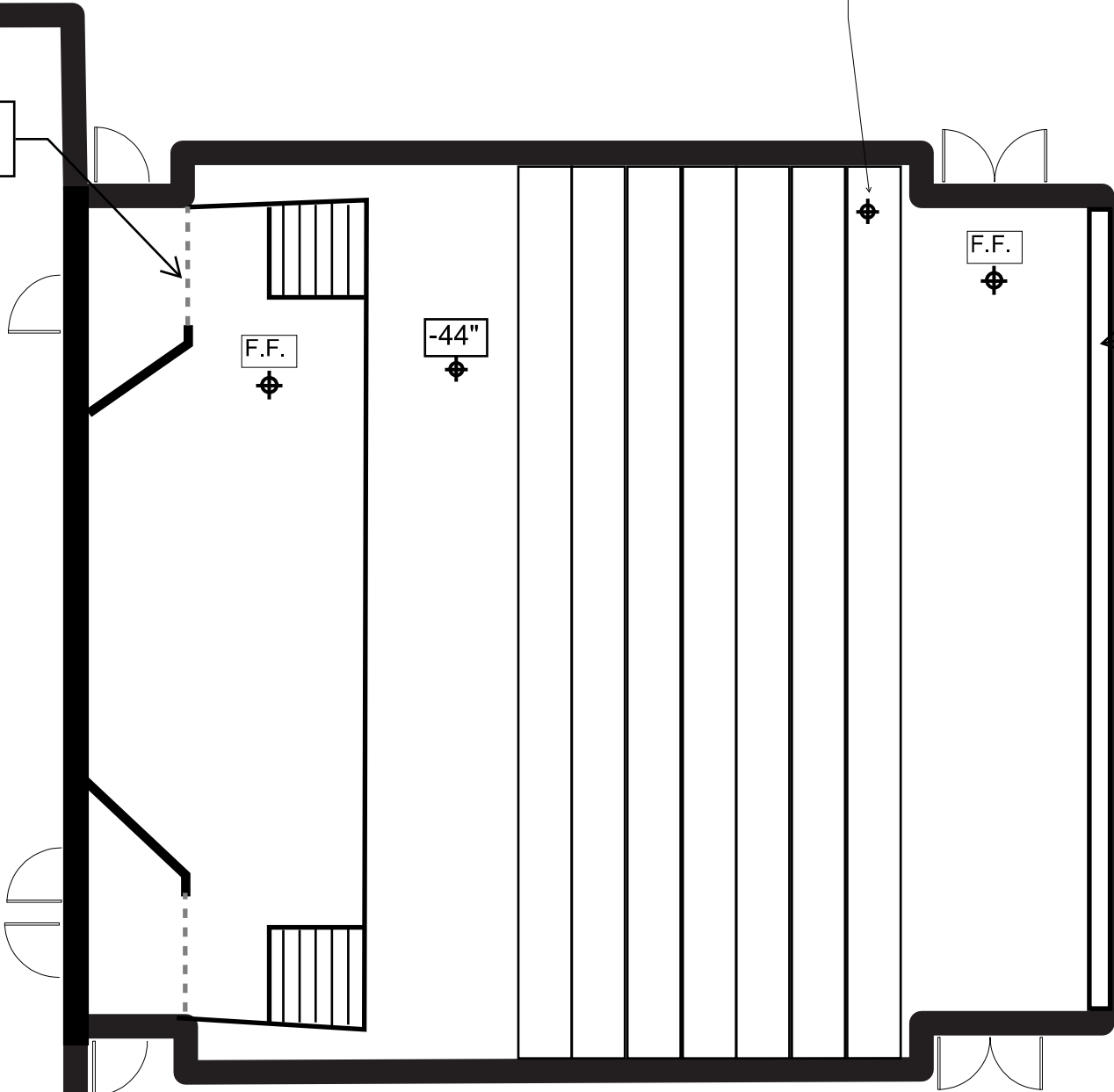

Antelope Valley College 14-220C  
Choral Room Renovation  
3/9/15

# FAS3

Wall line above Typ.

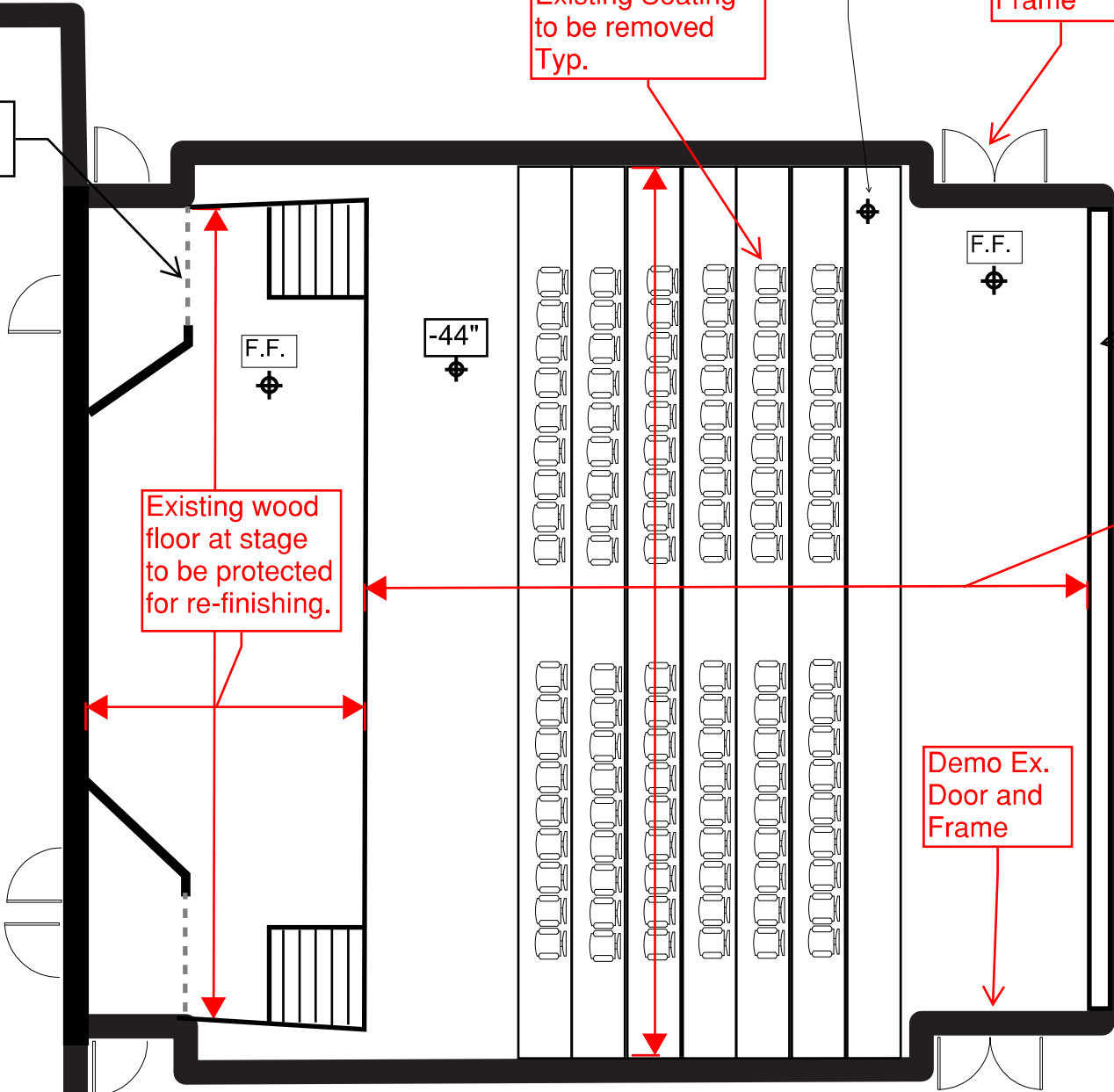

Existing Seating to be removed Typ.

Riser Elevation -5-1/2" Typ.

Demo Ex. Door and Frame

Existing Floor Plan

Existing wood floor at stage to be protected for re-finishing.

-44"

Demo Existing Vinyl Flooring Typ.

Existing in wall storage closets.

Demo Ex. Door and Frame



# FAS3

## New Seating Layout Floor Plan

Wall line above Typ.

Riser Elevation  
-5-1/2" Typ.

New Hussey Seating Quattro  
36" High Back  
Typ.

D-1

Existing in wall storage closets.

Hussey Seating Quattros

- (120) floor mount, 24" wide with 36" high back, self rising seats, grade 1 fabric, plastic outer back, seat pan and arm rests, plastic end panels. With T1 standard self-storing tablet arms, high pressure cast aluminum stanchions and ADA compliant transfer arms.

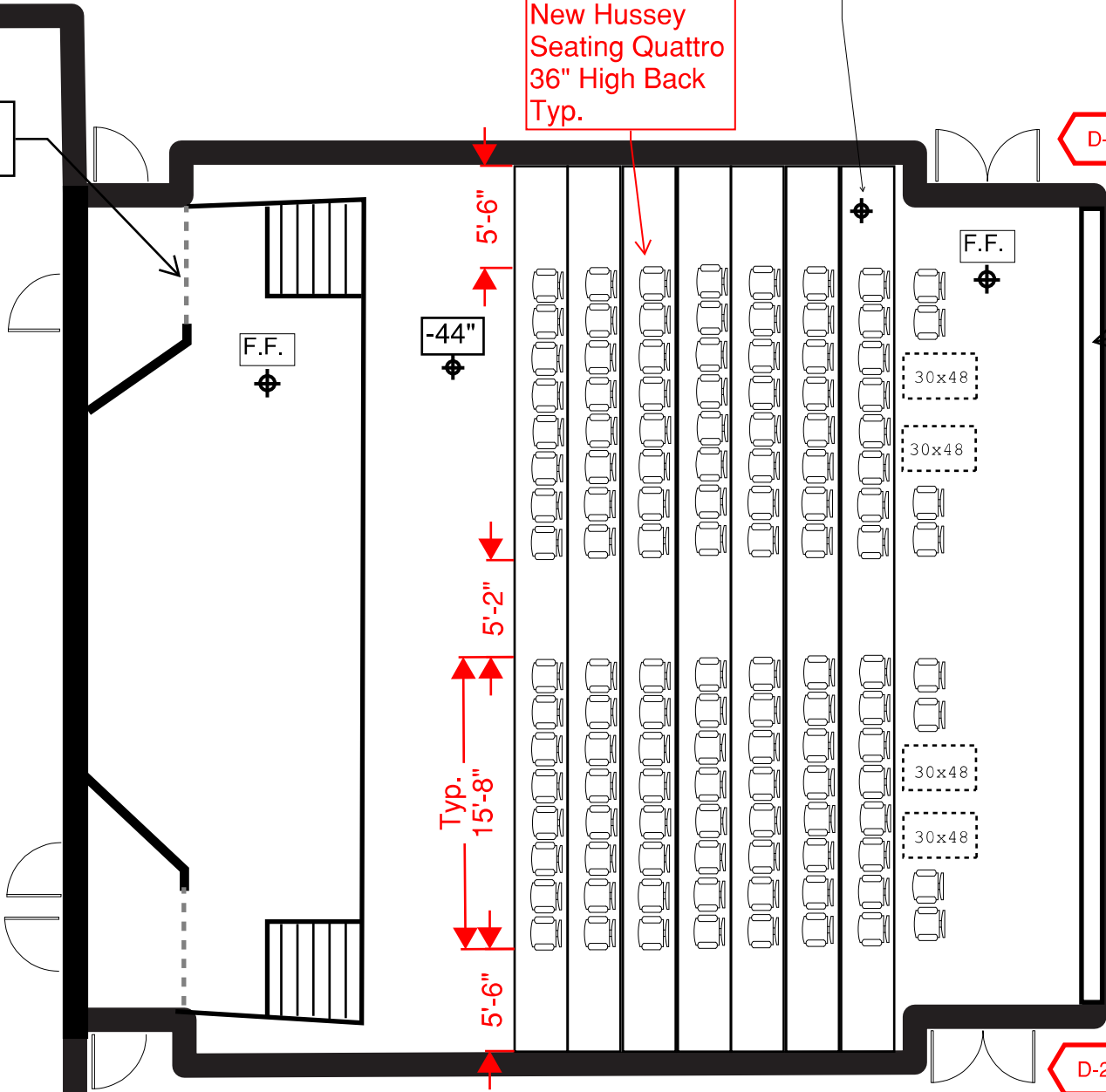

-44"

F.F.

30x48

30x48

30x48

30x48

D-2





# FAS3

Wall line above Typ.

New Armstrong Standard Excelone, Imperial Series 12"x12"x1/8"VCT Flooring Typ.  
See Detail 1/Flooring Details.

New Hussey Seating Quattro 36" High Back Typ.

Riser Elevation -5-1/2" Typ.

New Floor Plan

Re-finish Existing Wood Floor, stairs, and Fascia. Match Existing Color.

Existing in wall storage closets.

New Tandus Powerbond Rolled Flooring Carpet Typ. Style-Change II #03747, Color Cola #10805 See Detail 2/Flooring Details.

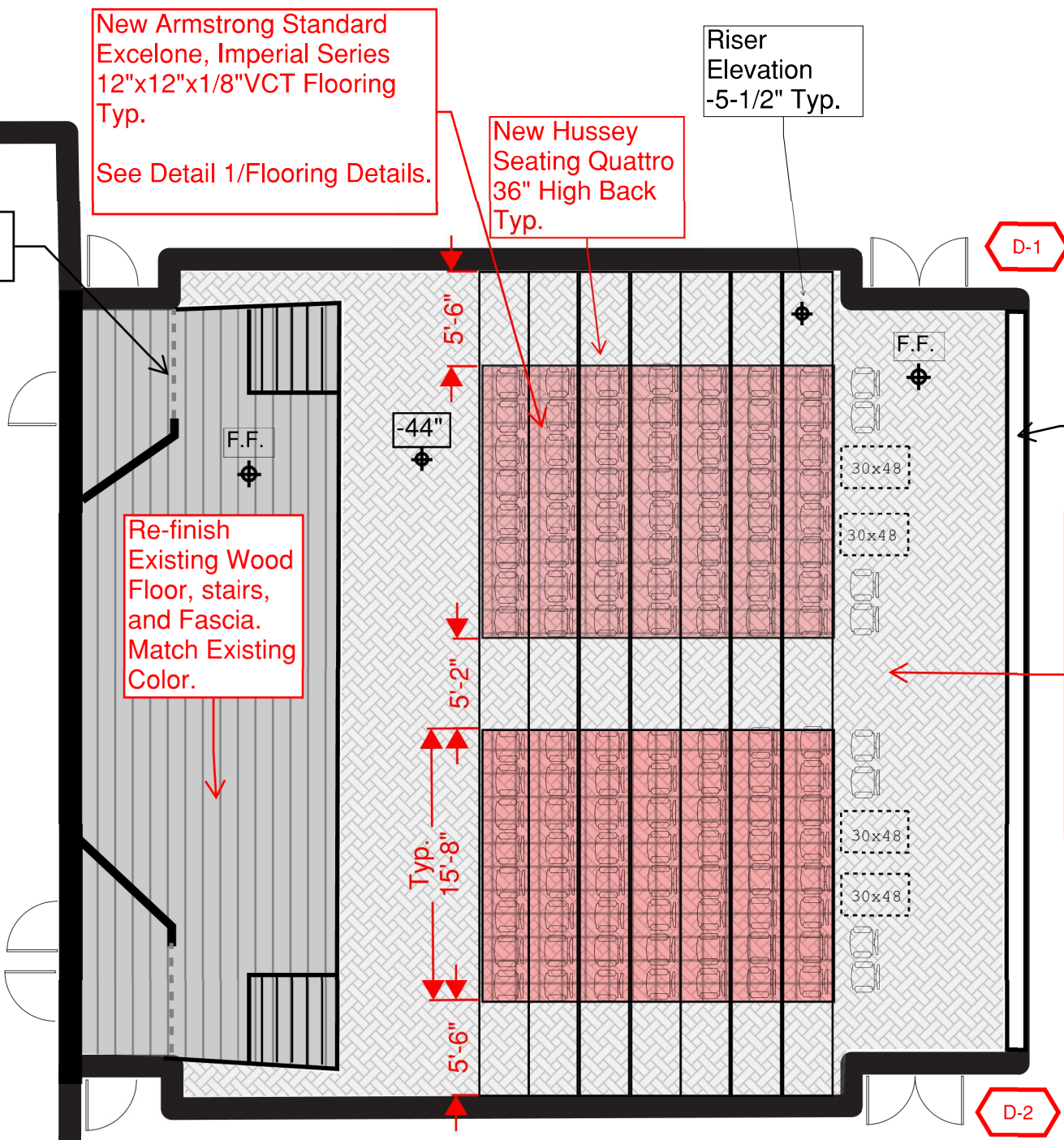

# FAS3

Wall line above Typ.

Riser Elevation  
-5-1/2" Typ.

Existing Dimensions and Wall Elevations

Existing in wall storage closets.

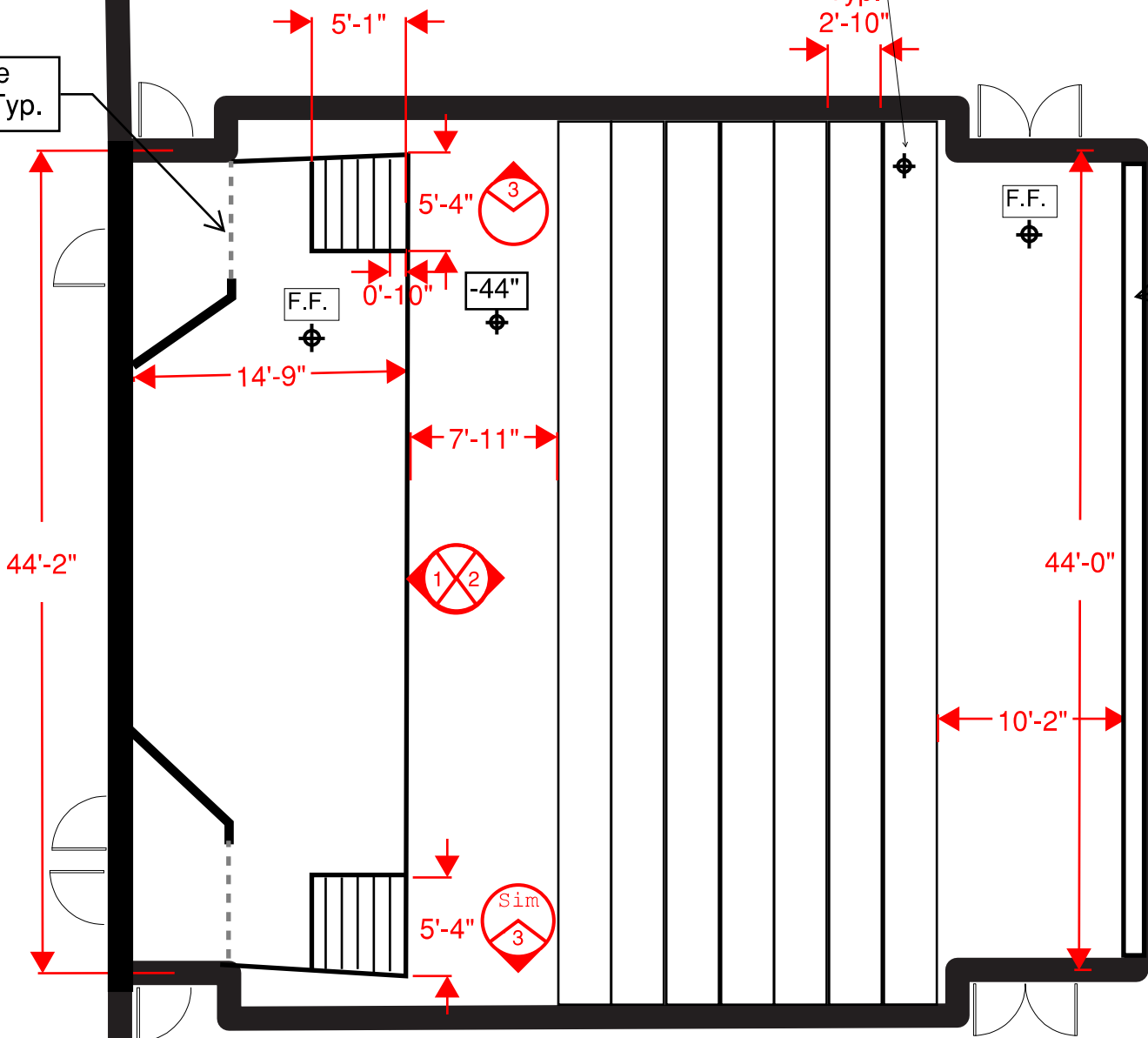



New Paint at all wall surfaces Typ. at all locations. Behr-Warm Cacocon #310C-3



Stage wall to be painted typical, stage fascia to be refinished to match wood floor.

New Paint at all wall surfaces Typ. Behr-Warm Cacocon #310C-3



New Paint at all wall surfaces Typ. Behr-Warm Cacocon #310C-3



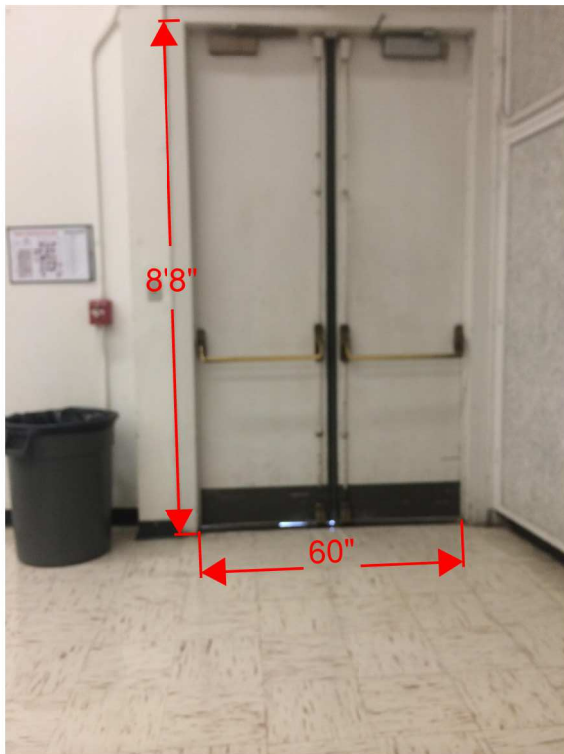

Existing Door and Frame D-1 and D-2 Similar.

Door Schedule



- New Fully Welded 14 ga. Hollow Metal Frame.
- New 16 ga. Hollow Metal Double Door.
- New Panic Hardware with vertical Rod Latching 9848L Von Duprin.
- Flush bolt latches at fixed leaf.
- New Closures 4040XP LCN.
- (8) New 4-1/2"x4" concealed bearing hinges (4 per door)
- New Lock sets (2) Schlage 9967RVM.
- New Door Seals, Door Sweeps and thresholds.
- Kick plates 10"H Aluminum Finish.

\*Work includes installation, attachment, adjustment and caulking of frame.

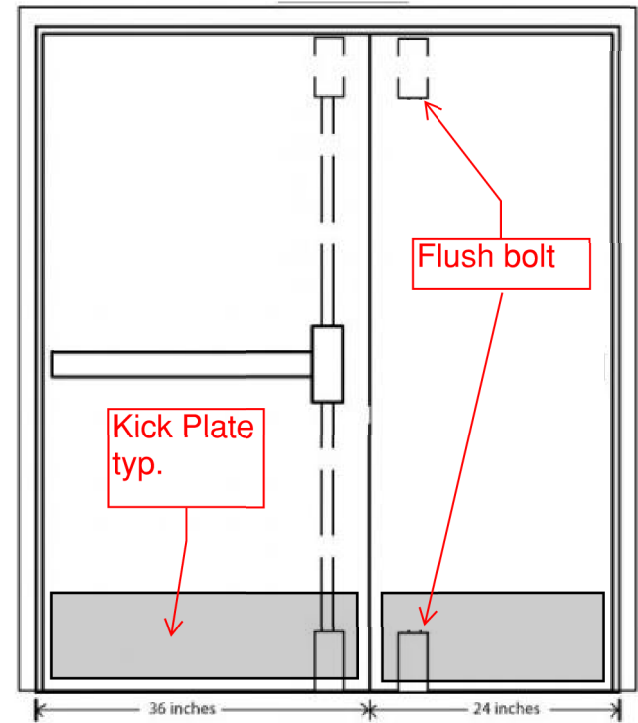

New Door Configuration, uneven leaf, no center mullion doors and frame.

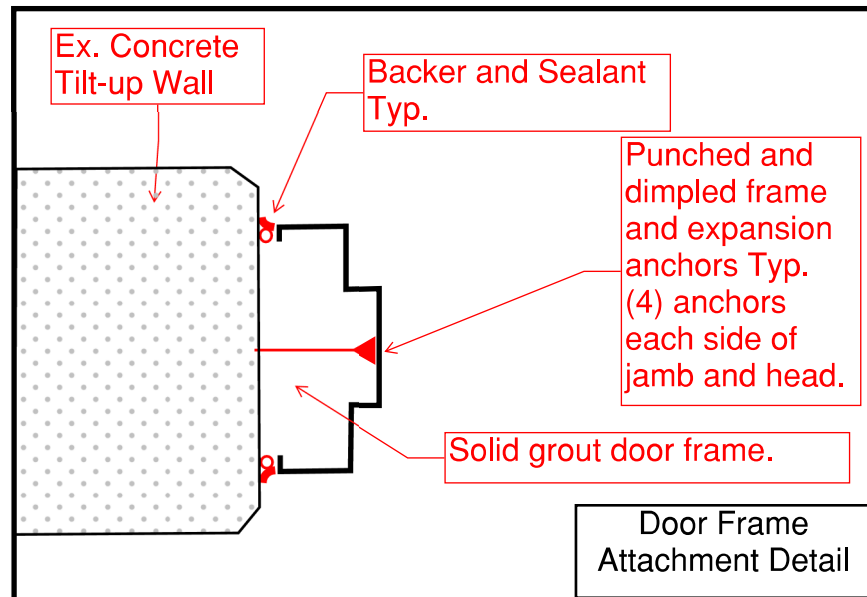

\*All material and dimensions must be field verified and field measured to ensure proper fit and configuration prior to ordering.



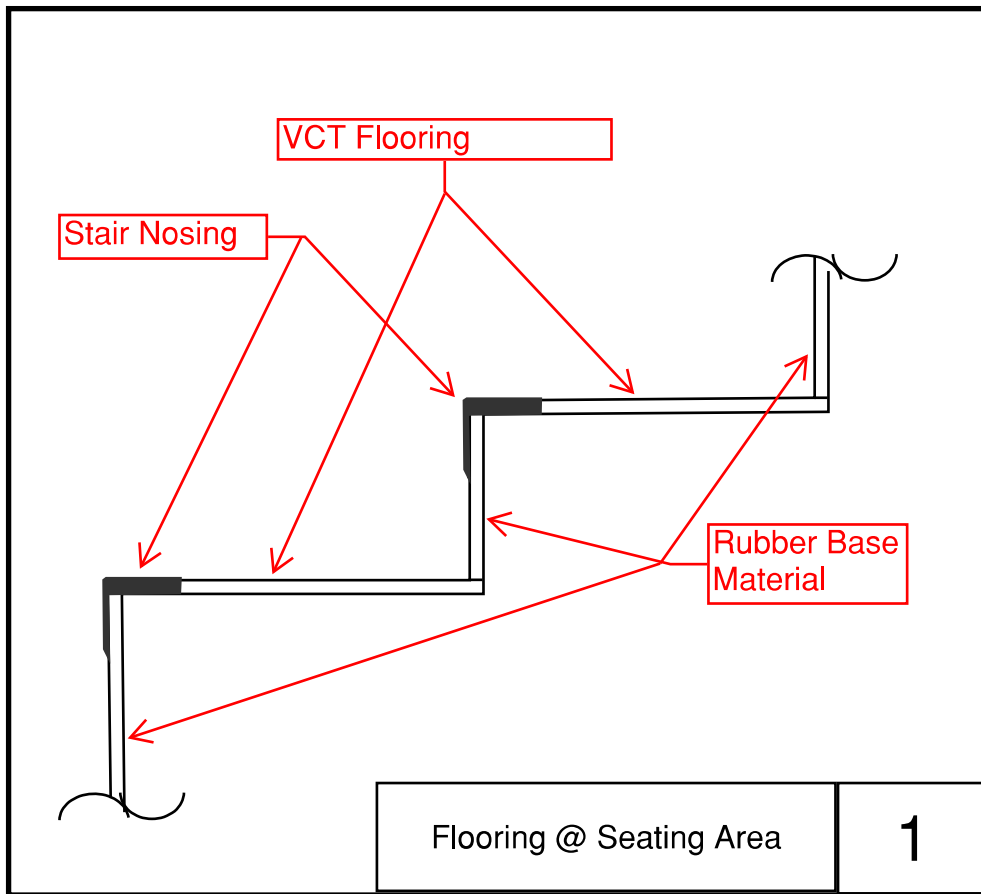

### VCT Flooring General Notes (Seating Area)

- \*Stair tread to be VCT, Riser to be base riser material.
- \*VCT stair nosing to be "Burke 585 Stair Nosing".
- \*Provide a "Burke 557 Visual Safety Nosing" top and bottom risers.
- \*Provide VCT to Carpet transition at riser (seat area).

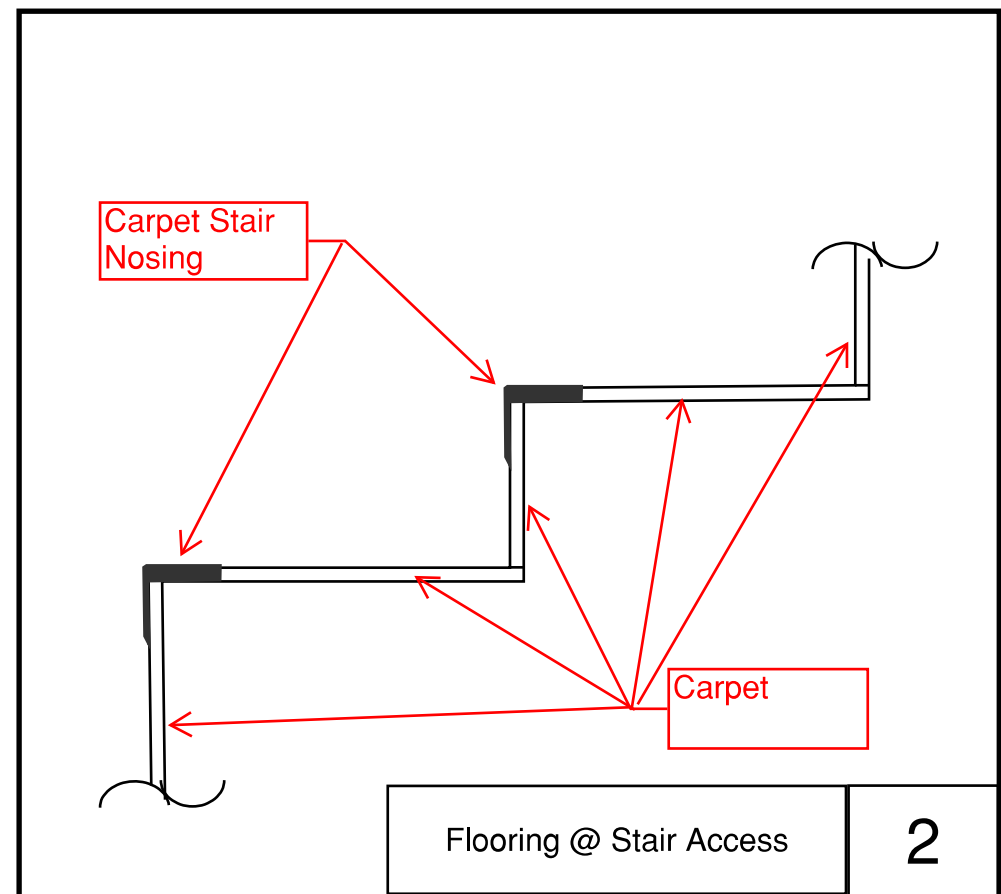

### Carpet General Notes (Stair Access)

- \*Stair tread and riser to be Carpet.
- \*Carpet stair nosing to be "Burke 570 Carpet Nosing".
- \*Provide Carpet to Base riser transition at risers (seat area).
- \*Provide Carpet to Base riser transition at riser (seat area).
- \*Provide a "Burke 557 Visual Safety Nosing" top and bottom riser.