

AREA EVACUATION MAP

NOTE: Evacuate your building via the shortest safest route to your building's evacuation assembly area.

ANTELOPE VALLEY COLLEGE
MAIN CAMPUS
 3041 West Avenue K
 Lancaster, CA 93536-5426
 (661) 722-6300 | ww.avc.edu



35th Street West

M

A

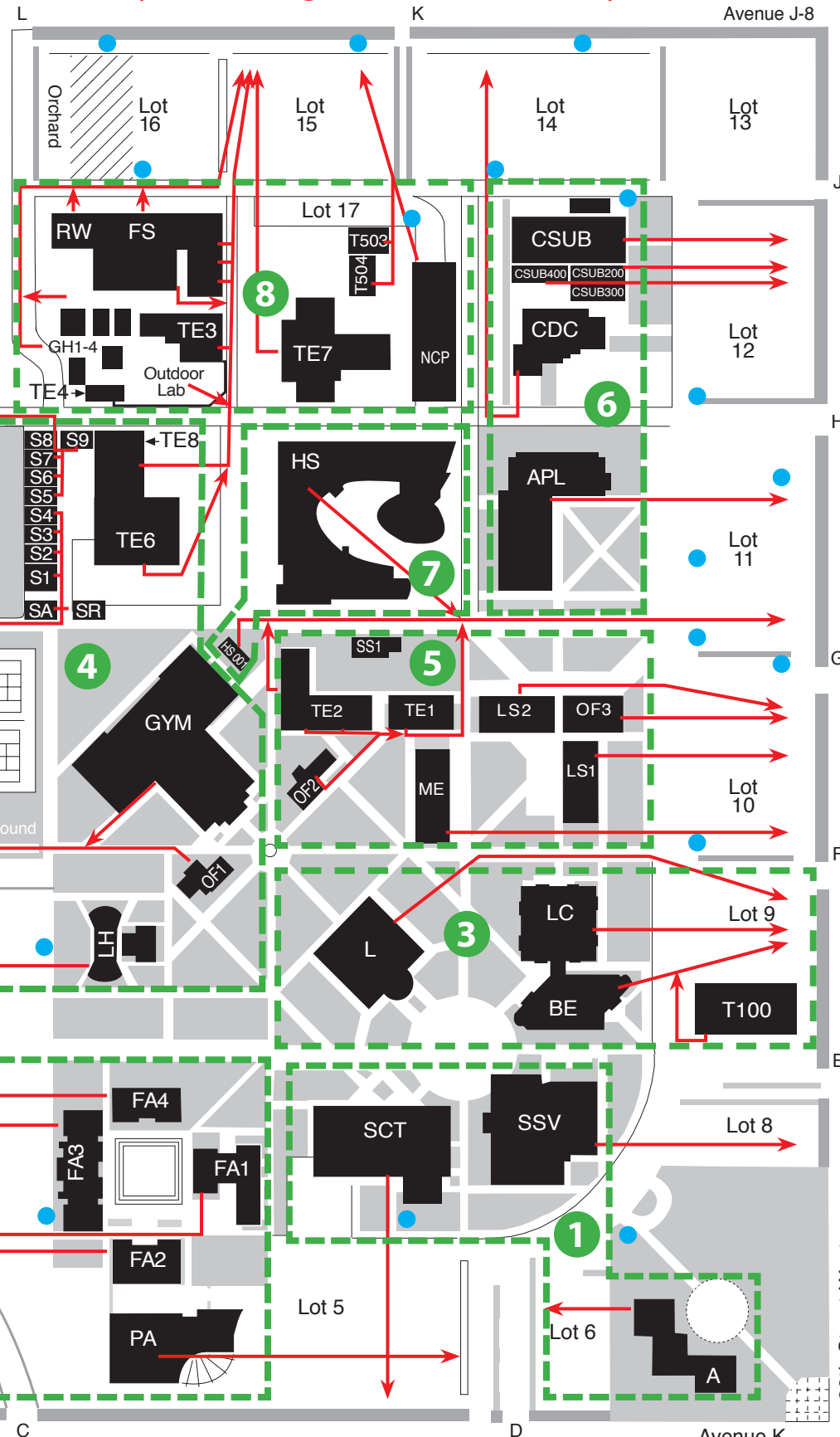

LEGEND	
A	Administration Bldg.
APL	Applied Arts, Allied Health, & Offices
BBS	Baseball Stadium
BE	Business Ed., IMC, & Offices
CDC	Child Development Center
CSUB	CSU Bakersfield-Antelope Valley
FA1	Fine Arts (Art & Gallery)
FA2	Fine Arts (Black Box)
FA3	Fine Arts (Music & Offices)
FA4	Fine Arts
FS	Facilities Services
GH1-4	Greenhouses
GYM	Gymnasium (PE & Offices)
HS	Health & Sciences Building
HS 001	Health & Sciences Greenhouse
L	Library
LC	Learning Center
LH	Lecture Halls
LS1	Liberal Studies & Offices
LS2	Liberal Studies
ME	Math/Engineering
MS1-2	Marauder Stadium
MS3	Marauder Stadium Ticket Booth
MS4	Marauder Stadium Concessions/Restrooms
NCP	North Central Plant
OF1	Offices: Math/Science
OF2	Offices: PE
OF3	Offices: Language Arts & Social Science
PA	Performing Arts Theatre
RW	Receiving/Warehouse
SA	Soar High School Administration
S1-9	Soar High School
SBS	Softball Stadium
SCT	Student Center (Bookstore, Cafeteria)
SR	Soar High School Restrooms
SS1	Electrical Substation
SSV	Student Services & Information
T100	Assessment/Office for Students with Disabilities
T503	Fire Technology
T800	LASD-AVC Unit (Security, Lost & Found)
T850-1	Field House: Home-Visitors
TE1	Technical Ed.—Electronics
TE2	Technical Ed.—Welding/Fire Technology
TE3	Technical Ed.—Agriculture Lab
TE4	Equipment Building
TE6	Technical Ed.—Automotive
TE7	Technical Ed.—Technology
TE8	Technical Ed.—Auto Body
●	Emergency Phone
Ⓜ	Helicopter Landing Zone

DRILL ZONES: 1 A, SSV, SCT 2 FA1-FA4, PA, NO. & SO. ATHLETIC FIELDS, MS1-4, T850-1 3 BE, L, LC, T100 4 LH, OF1, GYM, T800, SA, S1-S9, SR, SBS, TE6, TE8 5 LS1, LS2, ME, OF2, OF3, SS1, TE1, TE2 6 APL, CDC, CSUB 7 HS, HS001 8 FS, GH1-4, RW, T501-4, TE3-4, TE7, NCP
DRILL MONTH: 1 NOVEMBER 2 FEBRUARY 3 NOVEMBER 4 FEBRUARY 5 APRIL 6 SEPTEMBER 7 APRIL 8 SEPTEMBER